



THE UNITED KINGDOM VEHICLE APPROVAL AUTHORITY

COMMUNICATION CONCERNING THE APPROVAL GRANTED <sup>(1)</sup> / ~~APPROVAL EXTENDED <sup>(4)</sup> /  
APPROVAL REFUSED <sup>(4)</sup> / APPROVAL WITHDRAWN <sup>(4)</sup> / PRODUCTION DEFINITELY  
DISCONTINUED <sup>(4)</sup>~~ OF A TYPE OF PROTECTIVE HELMET WITHOUT / WITH <sup>(1)</sup> ONE / MORE <sup>(1)</sup>  
VISOR TYPE(S) WITHOUT / WITH <sup>(1)</sup> ONE / MORE <sup>(1)</sup> SPECIFIC ACCESSORY TYPE(S)  
PURSUANT TO UN REGULATION NO. 22.06



Approval No: E11\*22R06/02\*2246\*00

Reason(s) for Extension: Not applicable

1. Trade mark: AXOR, CLASSIC, SHIRO, TVS, TVS RACING, SUZUKI, YAMAHA, ATHOS, KENTO, ROYAL ENFIELD, VARDENCHI, HONDA, HERO, SHARK, SHOT, KONTROL, AVEX, KTM, KAWASAKI, VESPA, MMG, BENELLI, STORMER, BAJAJ, BADASS, KENTON, DELIVEROO, RUSH, ICH, SHAFT, SHAFTPRO, X-KOV, KOV, DYTONA, XSPORTS, UMA, SPARTAN, ISP, BDS, JET, REAL, HXP, AKT, NIKKO, SWT, GOMET, VERTIGO, BROKEN HEAD, DAABA SERVICES, NVG, ACCIONA, ATHER SPD, APRILIA, GENSLER & NORISK..
2. Type: STROMER DV "P"
3. Sizes: XL (61 cm), L (59-60 cm), M (57-58 cm), S (55-56 cm), XS (53-54 cm)
4. Manufacturer's name: Vega Auto Accessories Pvt. Ltd.
5. Address:  
  
Plot No. 12-B, Sy. No. 342,  
Bemciel Industrial Estate, Udyambag,  
Belgaum – 590 008, Karnataka, India
6. If applicable, name of manufacturer's representative: Not applicable
7. Address: Not applicable
8. Brief description of helmet: See manufacturer's information documents

9. Helmet ~~without lower face cover (J) / with protective lower face cover (P) / with non protective lower face cover (NP) / with detachable or movable lower face cover (P/J)~~<sup>(1)</sup>
10. Type of visor or visors: STROMER DUAL VISOR "P". also see visor approval E11\*22R06/02\*XXXX\*00
11. Brief description of visor or visors and inner visor if any: Outer visor & Sunshield inside the outer visor. See manufacturer's information documents
12. Helmet ready for specific accessory (SA) / ready for universal accessories (UA)<sup>(1)</sup>: Without accessories
13. Accessories included in the helmet homologation and functionality: Without accessories
14. If UA helmet, speakers (S or S45) / Microphone (M) / Front mounting (F) / Side mounting (L), Rear mounting (R)<sup>(1)</sup>: Not applicable
15. Submitted for approval on: 07 July 2025
16. Technical service responsible for conducting approval tests: Vehicle Certification Agency
17. Date of report issued by that service: 14 August 2025
18. Number of report issued by that service: VCA028034-1
19. Comments: Nil
20. Approval GRANTED / ~~EXTENDED / REFUSED / WITHDRAWN~~<sup>(1)</sup>

21. Place: BRISTOL

22. Date: 29 AUGUST 2025

23. Signature:

A handwritten signature in black ink that reads "C McCabe". The signature is written in a cursive style and is underlined with a single horizontal line.

C McCABE  
Chief Technical and Statutory Operations Officer

21. The following documents, bearing the approval number shown above, are available on request: Technical report & Manufacturer information document

(1) ~~Strike out what does not apply~~



Vehicle  
Certification  
Agency

THE UNITED KINGDOM VEHICLE APPROVAL AUTHORITY

APPROVAL NUMBER: E11\*22R06/02\*2246\*00

**INFORMATION PACKAGE CONTENTS**

**INDEX REVISION NUMBER: 00**

**Conformity of Production (COP) Declaration    COP Confirmed**

<b>Assessment Method</b>	<b>Compliance Statement</b>	
<b>Date of Initial Clearance</b>	<b>February</b>	<b>2016</b>
<b>Date of Last Clearance</b>	<b>April</b>	<b>2025</b>

Total number of sheets: 16 (Sixteen)

Reasons for Revision:    Not applicable

<b>Vega</b>	<b>Vega Auto Accessories Pvt. Ltd.</b> Plot No. 12-B, Sy. No. 342, Bemciel Industrial Estate, Udyambag, Belgaum – 590 008, Karnataka India	Doc No.	:	VA/STRMDV/01
		Date	:	08-07-2025
		Extension	:	00
<b>R22.06/ECE TYPE-APPROVAL OF PROTECTIVE HELMETS AND THEIR VISORS FOR DRIVERS AND PASSENGERS OF MOTORCYCLES AND MOPEDS</b>				

## INDEX OF DOCUMENTATION

### Sl. No. Description

1. GENERAL INFORMATION
2. DESCRIPTION OF THE HELMET / SHELL / RETENTION SYSTEM
3. RETENTION SYSTEM / PROTECTIVE PADDING
4. COMFORT PADDING/ OTHER CHARACTERISTICS
5. ACCESSORIES & USER INSTRUCTIONS
6. SHELL DRAWING -Annex-1
7. LARGE LINER DRAWING-Annex-2A
8. MEDIUM LINER DRAWING-Annex-2B
9. SIDE EPS DRAWING-Annex-3
10. MOUTH EPS, RIVET & SPOILER DRAWING-Annex-4
11. DOUBLE D-RING, QUICK RELEASE MECHANISM PART & CHINSTRAP ASSEMBLY DRAWING-Annex-5A & 5B
12. HELMET WITH SPOILER PHOTOS-Annex-6A
13. HELMET WITH SPOILER PHOTOS-Annex-6B



<b>Vega</b>	<b>Vega Auto Accessories Pvt. Ltd.</b> Plot No. 12-B, Sy. No. 342, Bemciel Industrial Estate, Udyambag, Belgaum – 590 008, Karnataka India	Doc No.	:	VA/STRMDV/01
		Date	:	08-07-2025
		Extension	:	00
<b>R22.06/ECE TYPE-APPROVAL OF PROTECTIVE HELMETS AND THEIR VISORS FOR DRIVERS AND PASSENGERS OF MOTORCYCLES AND MOPEDS</b>				

1. GENERAL INFORMATION

1.1 Make :- **VEGA**

1.2 Trademark: **AXOR, CLASSIC, SHIRO, TVS, TVS RACING, SUZUKI, YAMAHA, ATHOS, KENTO, ROYAL ENFIELD, VARDENCHI, HONDA, HERO, SHARK, SHOT, KONTROL, AVEX, KTM, KAWASAKI, VESPA, MMG, BENELLI, STORMER, BAJAJ, BADASS, KENTON, DELIVEROO, RUSH, ICH, SHAFT, SHAFTPRO, X-KOV, KOV, DYTONA, XSPORTS, UMA, SPARTAN, ISP, BDS, JET, REAL, HXP,AKT, NIKKO,SWT, GOMET, VERTIGO, BROKEN HEAD,DAABA SERVICES, NVG, ACCIONA, ATHER SPD, APRILIA, GENSLER & NORISK.**

1.2. Type : **STROMER DV "P"**

1.3. Variants : **N/A**

Versions : **N.A.**

1.4. Name and address of manufacturer:

**Vega Auto Accessories Pvt. Ltd.**  
**Plot No. 12B, Sy No 342**  
**Beciel Industrial Estate**  
**Udyambag, Belgaum – 590 008 Karnataka India**

1.5. Name and address of manufacturer's Assembly Plant :

**Vega Auto Accessories Pvt. Ltd.**  
**Plot No. 12B, Sy No 342**  
**Beciel Industrial Estate**  
**Udyambag, Belgaum – 590 008 Karnataka India**

1.6. If any,- name and address of manufacturer's authorized representative :

**Not applicable**

1.7. Location and method of affixing of the international approval mark:

**Marked in a label sewn to the retention system**



<b>Vega</b>	<b>Vega Auto Accessories Pvt. Ltd.</b> Plot No. 12-B, Sy. No. 342, Bemciel Industrial Estate, Udyambag, Belgaum - 590 008, Karnataka India	Doc No.	:	VA/STRMDV/01
		Date	:	08-07-2025
		Extension	:	00
<b>R22.06/ECE TYPE-APPROVAL OF PROTECTIVE HELMETS AND THEIR VISORS FOR DRIVERS AND PASSENGERS OF MOTORCYCLES AND MOPEDS</b>				

**2. DESCRIPTION OF THE HELMET**

2.1. Type of Helmet: **Integral/Jet/Modular**

2.2. Type of lower face cover: **"P" - Protective/ "NP" - Non Protective/ "J" / "P/J"**

2.3. : Sizes As below

Size (cm)		Weight (grams)
<b>XS</b>	<b>53-54</b>	1550 ± 50
<b>S</b>	<b>55-56</b>	1550 ± 50
<b>M</b>	<b>57-58</b>	1550 ± 50
<b>L</b>	<b>59-60</b>	1550 ± 50
<b>XL</b>	<b>61</b>	1550 ± 50

**3. SHELL**

3.1. Material : **ABS**

3.2. Beading : Window Beading - **EPDM Rubber**  
: Base Beading - **PVC (Poly Vinyl Chloride)**

3.3. Ventilation : **Yes**

3.3.1. Number of holes : **07**

3.3.2. Positioning on the shell: **Front Jaw, Top Vent Left & Right, Top Rear.**

**4. RETENTION SYSTEM**

4.1. Chin strap: See Detail in Ref. drawing no. : **Annex-5A & 5B**

Material: **Polyester**

4.1.2. Width: **21mm**



<b>Vega</b>	<b>Vega Auto Accessories Pvt. Ltd.</b> Plot No. 12-B, Sy. No. 342, Bemciel Industrial Estate, Udyambag, Belgaum – 590 008, Karnataka India	Doc No.	:	VA/STRMDV/01
		Date	:	08-07-2025
		Extension	:	00
<b>R22.06/ECE TYPE-APPROVAL OF PROTECTIVE HELMETS AND THEIR VISORS FOR DRIVERS AND PASSENGERS OF MOTORCYCLES AND MOPEDS</b>				

- 4.2. Retention system: **Chin Strap (Double D Ring)/ Quick Release Mechanism/~~Other~~**
- 4.3. Comfort padding of the retention system:
- 4.3.1. Composition:  
**Polyester cloth backed with polyurethane foam / synthetic leather or pure leather**
- 4.3.2. Thickness: **3 mm**
- 4.4. Fixing system to the shell:  
**By Rivets Ø4.0mmx10mm, 2 Nos. (Refer Annex-4)**
- 5. PROTECTIVE PADDING**
- 5.1. Number of pieces: 3
- 5.2. Composition:  
**Expanded Polystyrene (Ref. Attached Drawing Annex 2A,2B & 3)**
- 5.3. Density:  
**(1) 65 kg/m<sup>3</sup> (Main part ) For XS (53-54), S (55-56)- 580mm**  
**(2) 65 kg/m<sup>3</sup> (Main part) For M(57-58), L (59-60), XL (61)- 620mm**  
**(3) 70 kg/m<sup>3</sup> (Side part ) For XS (53-54),S(55-56),M(57-58),L(59-60),XL (61)**  
**(4) 70 kg/m<sup>3</sup>(Mouth part ) For XS (53-54),S(55-56),M(57-58),L(59-60),XL (61)**
- 6. COMFORT PADDING**
- 6.1. Composition of:
- Comfort padding : **Polyurethane foam**
- Comfort tissue : **Polyester cloth**
- Protection of the back of the neck: **Polyester cloth backed with PU foam**
- 7. OTHER CHARACTERISTICS**
- 7.1. Indelible marking:



<b>Vega</b>	<b>Vega Auto Accessories Pvt. Ltd.</b> Plot No. 12-B, Sy. No. 342, Bemciel Industrial Estate, Udyambag, Belgaum – 590 008, Karnataka India	Doc No.	:	VA/STRMDV/01
		Date	:	08-07-2025
		Extension	:	00
<b>R22.06/ECE TYPE-APPROVAL OF PROTECTIVE HELMETS AND THEIR VISORS FOR DRIVERS AND PASSENGERS OF MOTORCYCLES AND MOPEDS</b>				

Place of Trade Mark	Back of the helmet
Place of Approval Mark	Swen in to the retention system
Place of weight mark	Back side of the helmet
Place of size mark	Back side of the helmet & Swen in to the Headband
Place of information to wearers	Swen in to the Headband

## 8. ACCESSORIES

### 8.1. Spoiler

### 8.2. User's instructions

#### 8.2.1 Text:

- ❖ "For adequate protection, this helmet must fit closely and be securely attached. Any helmet that has sustained a violent impact should be replaced"
- ❖ "'Warning' - Do not apply paint,stickers, petrol or other solvents to this helmet".
- ❖ The fastening of this visor is such that it will not be possible to remove it instantly from the line of sight with one hand should an emergency (such as headlamp glare or misting) occur.
- ❖ Allow adequate peripheral vision, especially when wearing goggles or other eye protection. Tinted goggles or face shield should not be worn at night (Daytime use only) or in any condition of poor visibility.
- ❖ Storage and care, When not in use, always store your helmets at room temperature in its original bag.Do not store in damp places, whatever the degree of environmental humidity.Do not store in warm places or close to heat sources (such as heaters)

#### 8.2.2. Location:

Swen in to the Headband



<b>Vega</b>	<b>Vega Auto Accessories Pvt. Ltd.</b> Plot No. 12-B, Sy. No. 342, Bemciel Industrial Estate, Udyambag, Belgaum - 590 008, Karnataka India	Doc No. :	VA/STRMDV/01
		Date :	08-07-2025
		Extension :	00
<b>R22.06/ECE TYPE-APPROVAL OF PROTECTIVE HELMETS AND THEIR VISORS FOR DRIVERS AND PASSENGERS OF MOTORCYCLES AND MOPEDS</b>			

Annex-1  
SHELL DRAWING

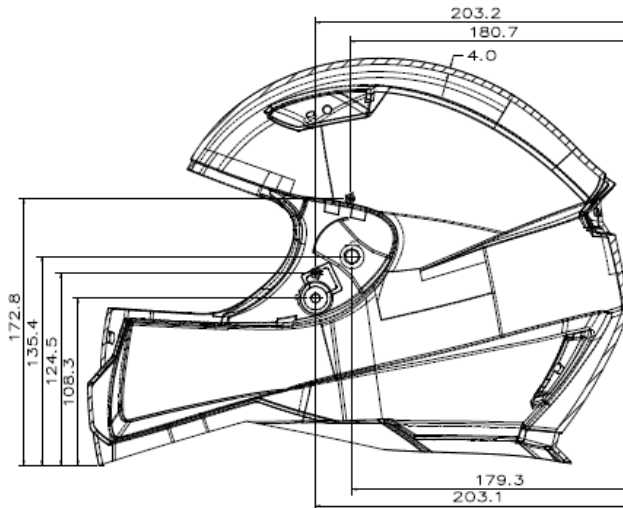
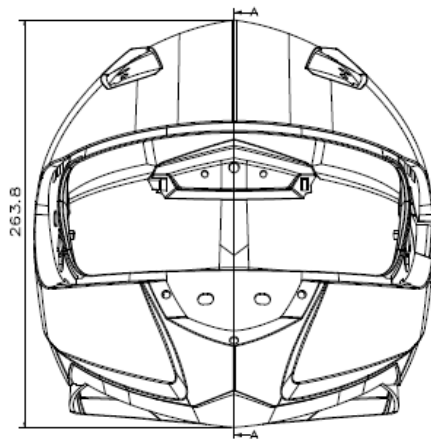
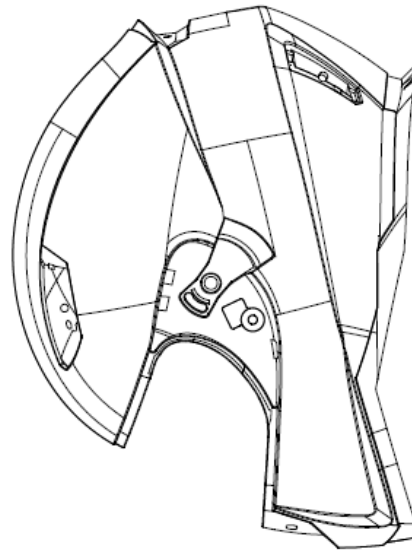
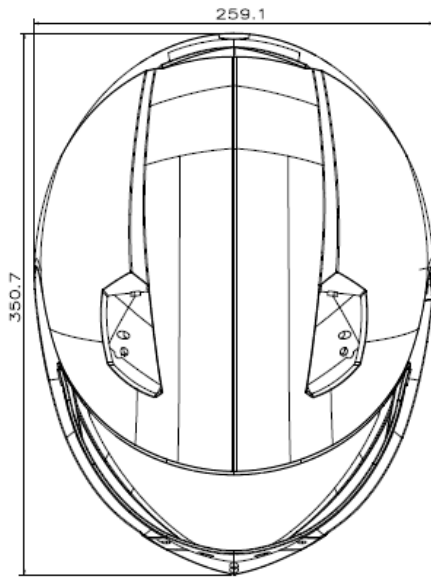

SECTION A-A

	<b>Vega Auto Accessories Pvt. Ltd.</b> Plot No. 12-B, Sy. No. 342, Bemciel Industrial Estate, Udyambag, Belgaum - 590 008, Karnataka India	Doc No.	:	VA/STRMDV/01
		Date	:	08-07-2025
		Extension	:	00
<b>R22.06/ECE TYPE-APPROVAL OF PROTECTIVE HELMETS AND THEIR VISORS FOR DRIVERS AND PASSENGERS OF MOTORCYCLES AND MOPEDS</b>				

Annex-2A  
LARGE LINER DRAWING

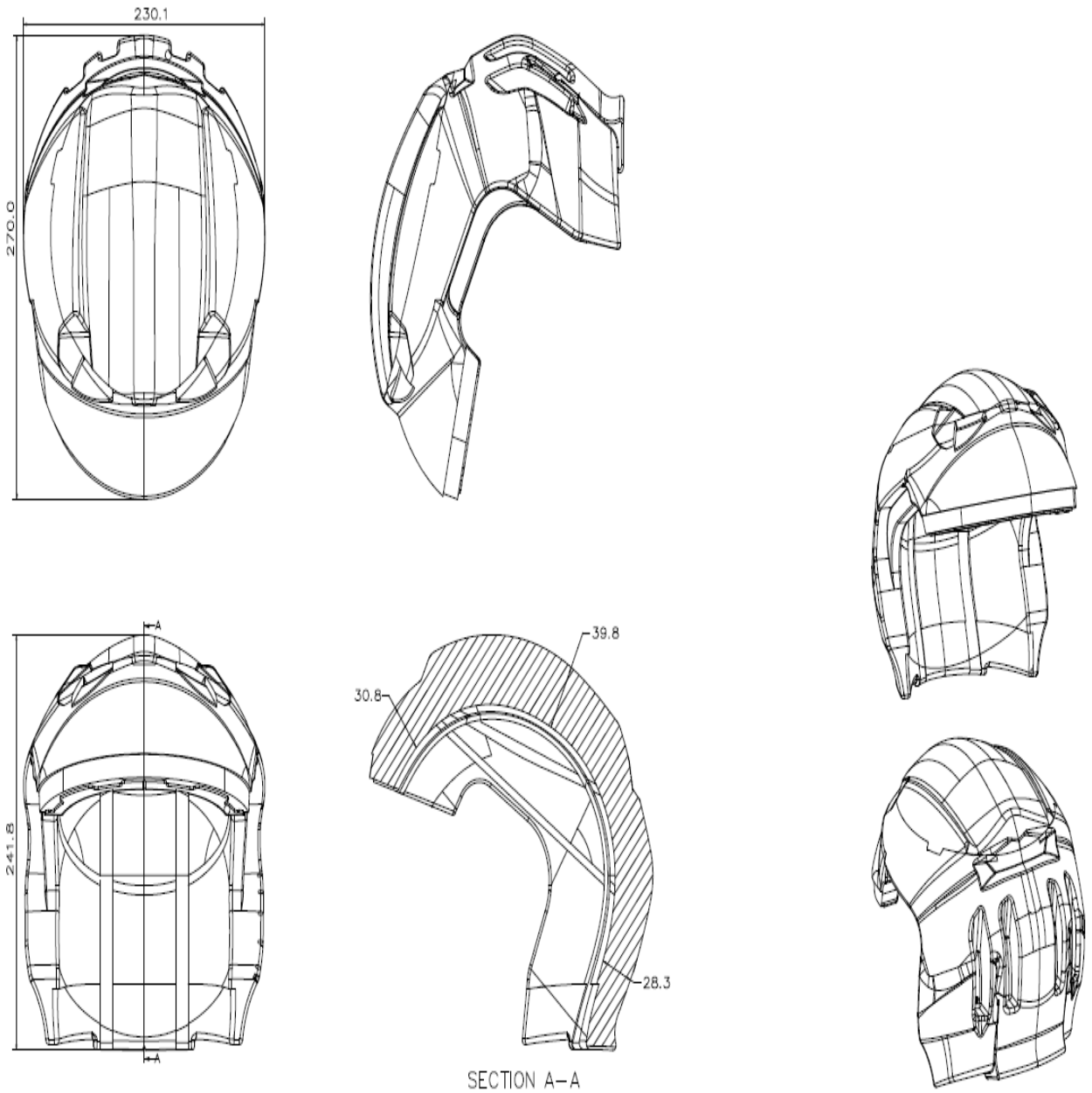

	<b>Vega Auto Accessories Pvt. Ltd.</b> Plot No. 12-B, Sy. No. 342, Bemciel Industrial Estate, Udyambag, Belgaum - 590 008, Karnataka India	Doc No. :	VA/STRMDV/01
		Date :	08-07-2025
		Extension :	00
<b>R22.06/ECE TYPE-APPROVAL OF PROTECTIVE HELMETS AND THEIR VISORS FOR DRIVERS AND PASSENGERS OF MOTORCYCLES AND MOPEDS</b>			

Annex-2B  
MEDIUM LINER DRAWING

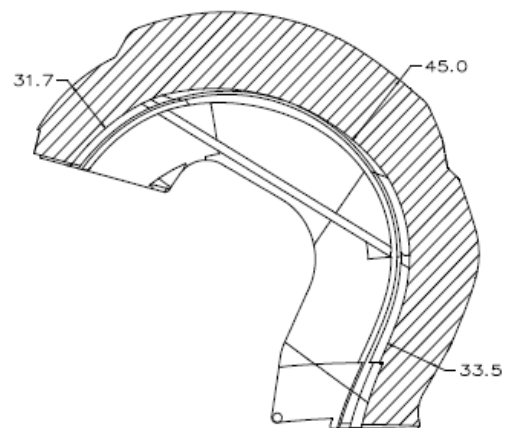
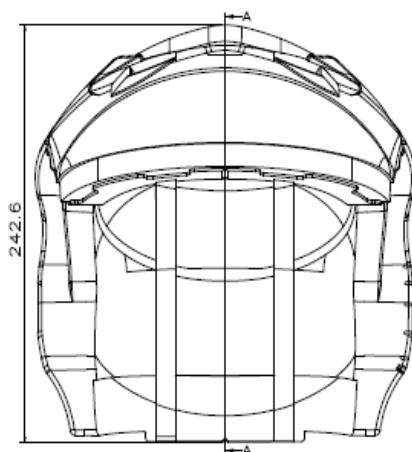
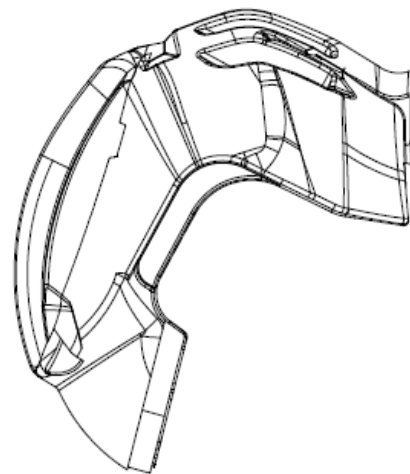
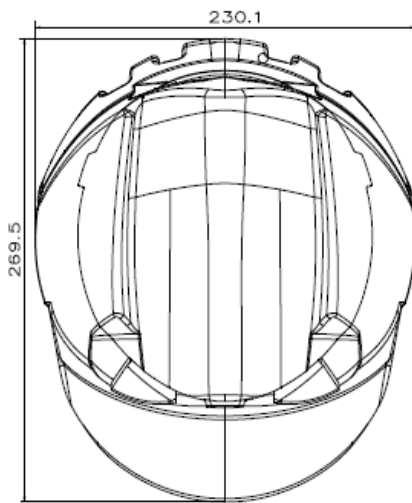

SECTION A-A

	<b>Vega Auto Accessories Pvt. Ltd.</b> Plot No. 12-B, Sy. No. 342, Bemciel Industrial Estate, Udyambag, Belgaum - 590 008, Karnataka India	Doc No. :	VA/STRMDV/01
		Date :	08-07-2025
		Extension :	00
<b>R22.06/ECE TYPE-APPROVAL OF PROTECTIVE HELMETS AND THEIR VISORS FOR DRIVERS AND PASSENGERS OF MOTORCYCLES AND MOPEDS</b>			

Annex-3  
SIDE EPS DRAWING

LEFT SIDE EPS DRAWING

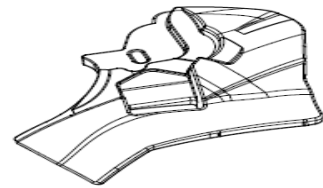
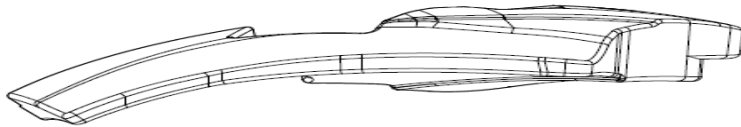
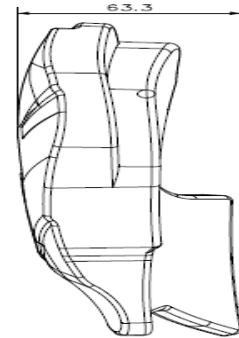
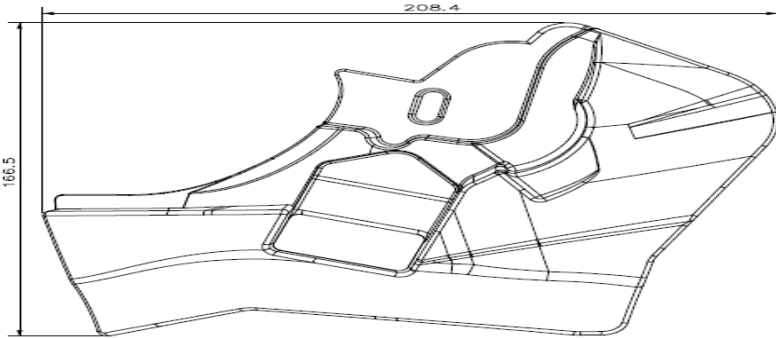

RIGHT SIDE EPS DRAWING

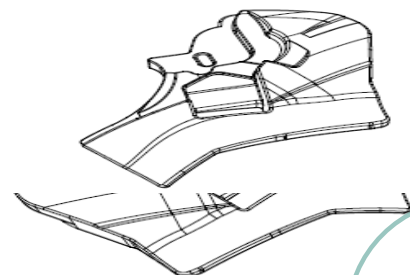
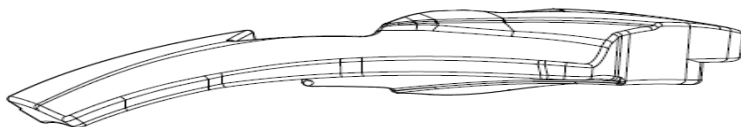
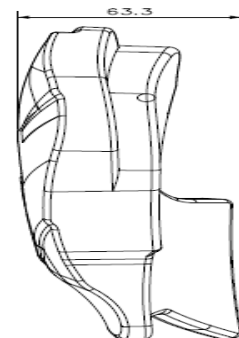
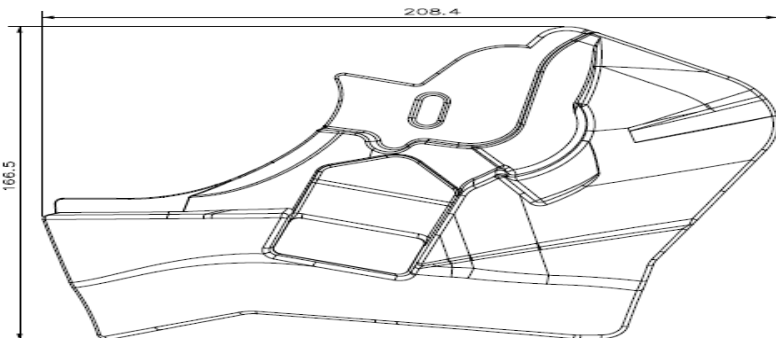

<b>Vega</b>	<b>Vega Auto Accessories Pvt. Ltd.</b> Plot No. 12-B, Sy. No. 342, Bemciel Industrial Estate, Udyambag, Belgaum - 590 008, Karnataka India	Doc No.	:	VA/STRMDV/01
		Date	:	08-07-2025
		Extension	:	00
<b>R22.06/ECE TYPE-APPROVAL OF PROTECTIVE HELMETS AND THEIR VISORS FOR DRIVERS AND PASSENGERS OF MOTORCYCLES AND MOPEDS</b>				

**MOUTH EPS, RIVET & SPOILER**

**MOUTH EPS**

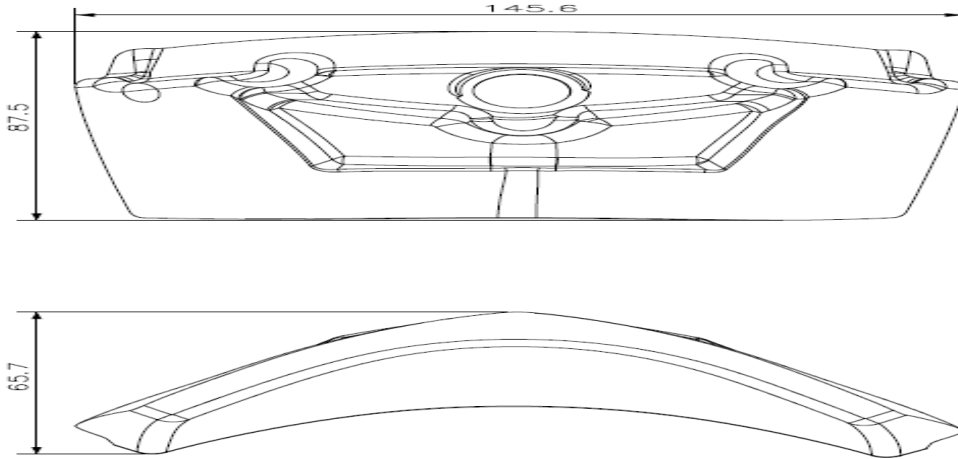

**RIVET**

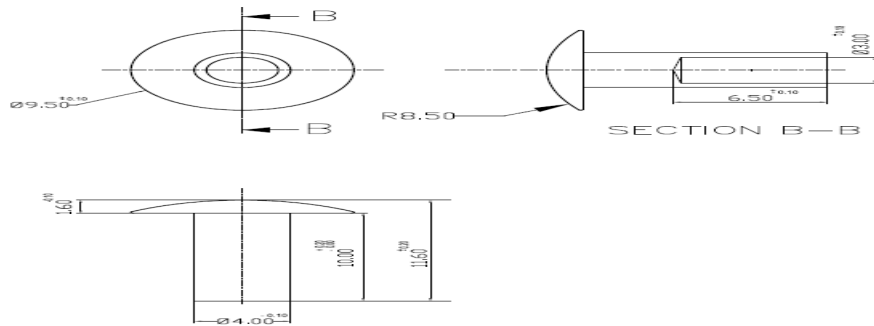

**SPOILER**

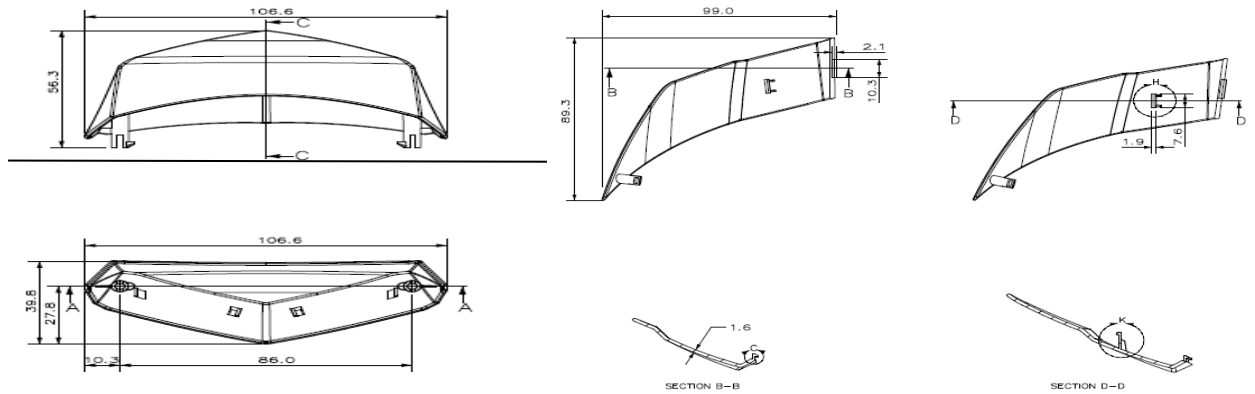

<b>Vega</b>	<b>Vega Auto Accessories Pvt. Ltd.</b> Plot No. 12-B, Sy. No. 342, Bemciel Industrial Estate, Udyambag, Belgaum - 590 008, Karnataka India	Doc No. :	VA/STRMDV/01
		Date :	08-07-2025
		Extension :	00
<b>R22.06/ECE TYPE-APPROVAL OF PROTECTIVE HELMETS AND THEIR VISORS FOR DRIVERS AND PASSENGERS OF MOTORCYCLES AND MOPEDS</b>			

**Annex-5A  
Double D-Ring**

**DRAWING NO:VA-19-AXC-24**

**BUCKLE 1**

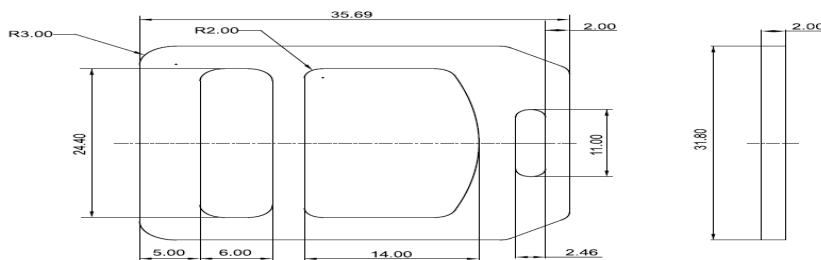

**DRAWING NO:VA-19-AXC-25**

**BUCKLE 2**

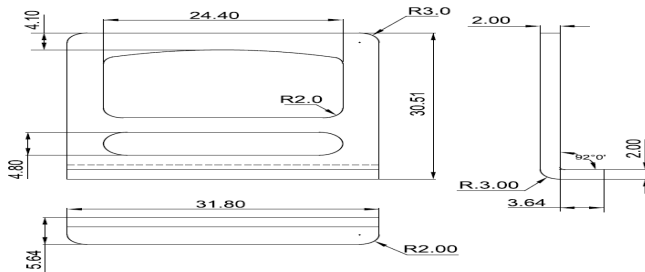

**CHIN STRAP ASSEMBLY  
DRAWING NO: VA-19-AXC-26**

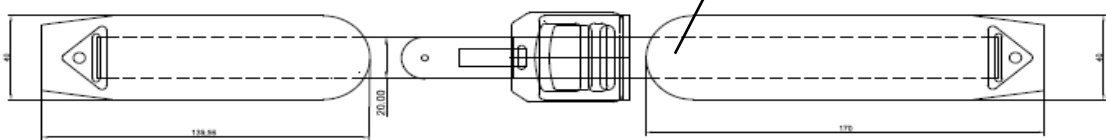

<b>Vega</b>	<b>Vega Auto Accessories Pvt. Ltd.</b> Plot No. 12-B, Sy. No. 342, Bemciel Industrial Estate, Udyambag, Belgaum - 590 008, Karnataka India	Doc No. :	VA/STRMDV/01
		Date :	08-07-2025
		Extension :	00
<b>R22.06/ECE TYPE-APPROVAL OF PROTECTIVE HELMETS AND THEIR VISORS FOR DRIVERS AND PASSENGERS OF MOTORCYCLES AND MOPEDS</b>			

**Annex-5B**  
**Quick Release Mechanism**

**BUCKLE LATCH PART**  
**PART NO: VAA/MLK/C/01**

*BUCKLE LATCH PART*

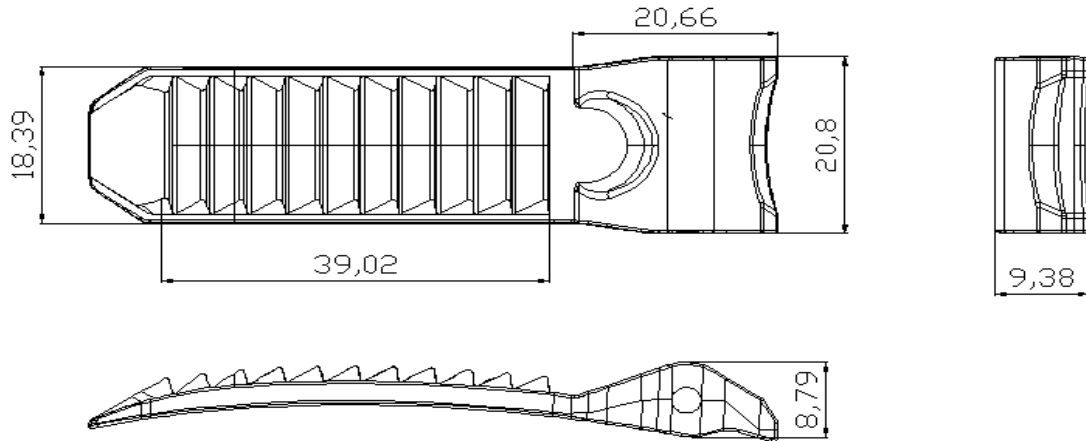

**BUCKLE PART**  
**PART NO: VAA/LMLK/C/02**

*BUCKLE PART*

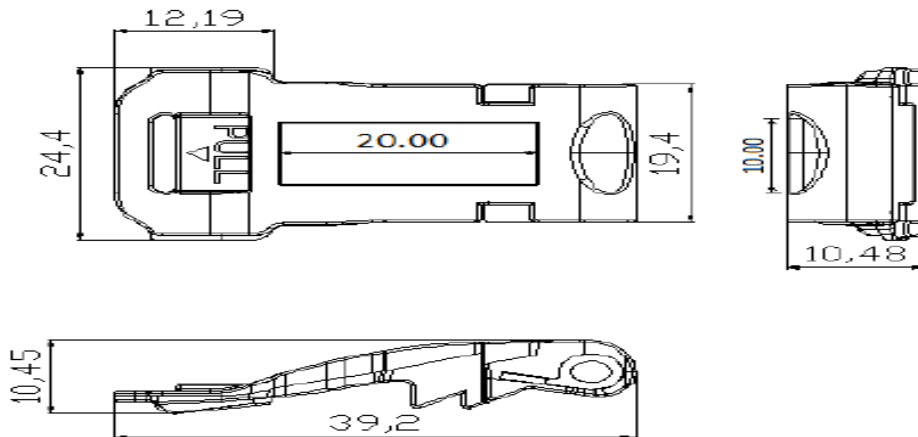

<b>Vega</b>	<b>Vega Auto Accessories Pvt. Ltd.</b> Plot No. 12-B, Sy. No. 342, Bemciel Industrial Estate, Udyambag, Belgaum - 590 008, Karnataka India	Doc No.	:	VA/STRMDV/01
		Date	:	08-07-2025
		Extension	:	00
<b>R22.06/ECE TYPE-APPROVAL OF PROTECTIVE HELMETS AND THEIR VISORS FOR DRIVERS AND PASSENGERS OF MOTORCYCLES AND MOPEDS</b>				

**BUCKLE HOUSING METAL PART**  
**PART NO:VAA/MLK/C/03**

*BUCKLE HOUSING METAL PART*

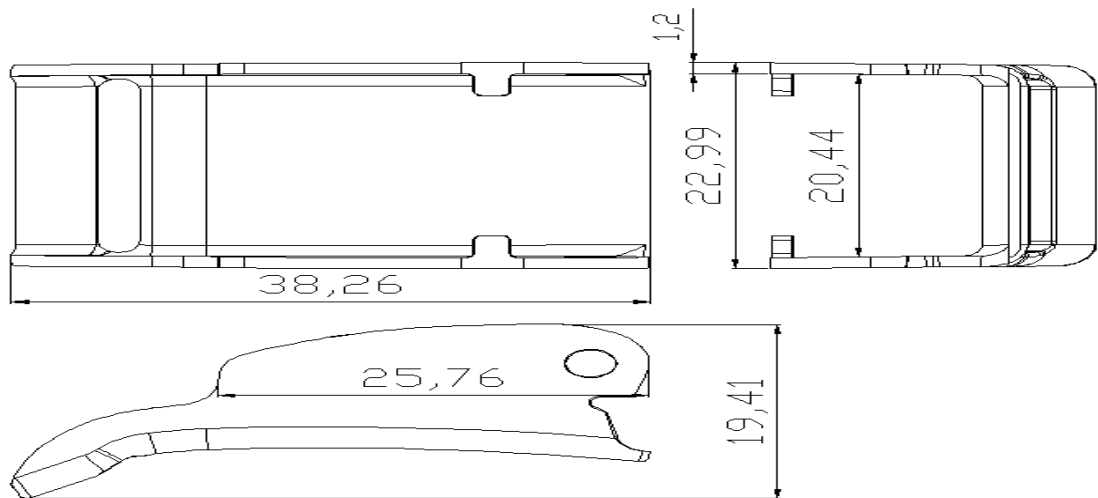

**BUCKLE LATCH HOUSING METAL PART**  
**PART NO: VAA/MLK/C/04**

*BUCKLE HOUSING METAL PART*

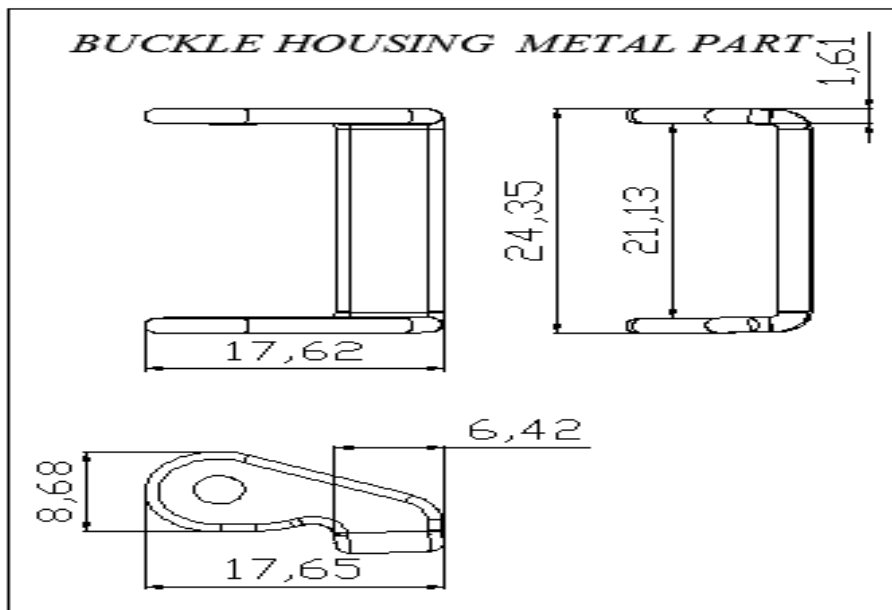

<b>Vega</b>	<b>Vega Auto Accessories Pvt. Ltd.</b> Plot No. 12-B, Sy. No. 342, Bemciel Industrial Estate, Udyambag, Belgaum - 590 008, Karnataka India	Doc No.	:	VA/STRMDV/01
		Date	:	08-07-2025
		Extension	:	00
<b>R22.06/ECE TYPE-APPROVAL OF PROTECTIVE HELMETS AND THEIR VISORS FOR DRIVERS AND PASSENGERS OF MOTORCYCLES AND MOPEDS</b>				

**PART NO:VAA/MLK/C/05**

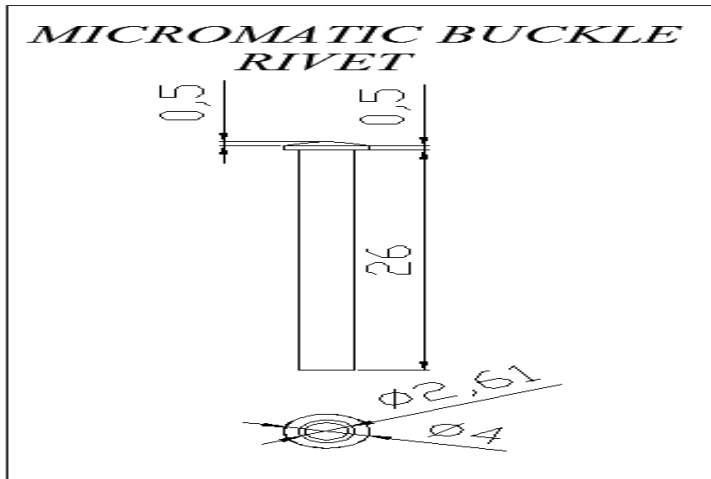

**CHINSTRAP ASSEMBLY DRAWING**

**PART NO :-VAA/MLK/C/06**

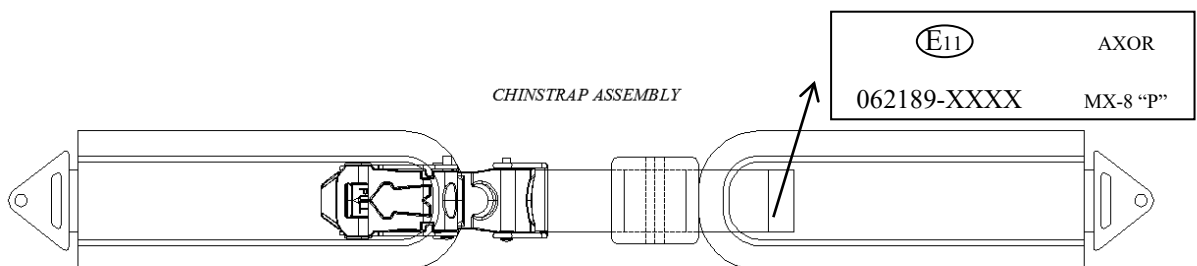
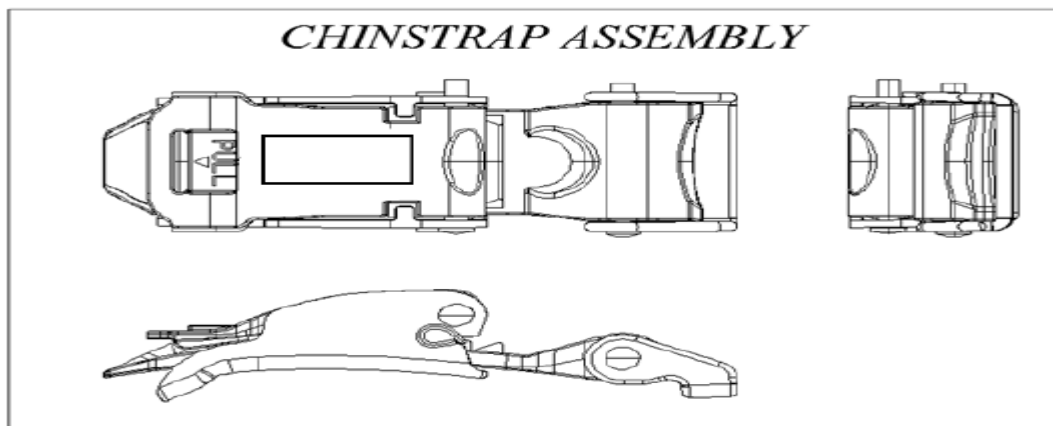

<b>Vega</b>	<b>Vega Auto Accessories Pvt. Ltd.</b> Plot No. 12-B, Sy. No. 342, Bemciel Industrial Estate, Udyambag, Belgaum - 590 008, Karnataka India	Doc No.	:	VA/STRMDV/01
		Date	:	08-07-2025
		Extension	:	00
<b>R22.06/ECE TYPE-APPROVAL OF PROTECTIVE HELMETS AND THEIR VISORS FOR DRIVERS AND PASSENGERS OF MOTORCYCLES AND MOPEDS</b>				

**Annex-6A**  
HELMET WITH SPOILER PHOTOS



<b>Vega</b>	<b>Vega Auto Accessories Pvt. Ltd.</b> Plot No. 12-B, Sy. No. 342, Bemciel Industrial Estate, Udyambag, Belgaum - 590 008, Karnataka India	Doc No.	:	VA/STRMDV/01
		Date	:	08-07-2025
		Extension	:	00
<b>R22.06/ECE TYPE-APPROVAL OF PROTECTIVE HELMETS AND THEIR VISORS FOR DRIVERS AND PASSENGERS OF MOTORCYCLES AND MOPEDS</b>				

**Annex-6B**  
ASSEMBLY HELMET WITHOUT SPOILER PHOTOS





## Inspection/Test Report: Protective Helmets and their Visors for Drivers and Passengers of Motorcycles and Mopeds

### Legislation

UNECE Regulation 22.06 Consolidated to Supplement 2 (Revision 5 Amendment 2)

### Inspection/Test Details

Location of Inspection/Test: Vega Auto Accessories Pvt. Ltd. Testing Laboratory -  
Belgaum  
Date(s) of Inspection/Test: 10 July 2025 to 11 July 2025  
VCA Representative(s): Swapnil S Mandekar/Ravi Reddy  
Engineers Home Office Location: VCA India  
Manufacturer's Representative(s): Sandip Kumbhar / Bhavesh Tupare  
Reason for Report: New Approval

### Manufacturer Details

Name and Address: Vega Auto Accessories Pvt. Ltd.  
Plot No. 12B, Sy No 342  
Bemciel Industrial Estate  
Udyambag, Belgaum – 590 008 Karnataka India  
Type: STROMER DV "P"  
Commercial Description: Protective helmet with full face "P" type provided with outer  
Visor  
Category: Not applicable

### Conclusion

The above-mentioned vehicle / engine / component was tested in accordance with the above mentioned legislation and was found to comply in all respects listed in this report. This report relates only to the items tested.

Test Report Engineer  
Signature:

Name: Swapnil S Mandekar  
Position: Type Approval Engineer  
Date: 14 August 2025

### List of Annexes

Annex	No of Pages	Subject
I	11	Production qualification report
II	--	--
III	--	--





### Issue Record

Issue	Reason for re issue	Name of competent engineer re issuing	Date of re issue
0	Issue 0 is the original report		
--	--	--	--
--	--	--	--

### Worst Case Rationale

Representative protective helmets tested for approval as submitted by manufacturer.  
Protective helmet type STROMER "DV" helmet provided with outer visor. Visor certificate number:  
E11\*22R06/02\*XXXX\*00  
There are two retention system provided tested for both the system.

*Note: Include information on variants and versions this report covers, as applicable. Supporting documents may be annexed to this report.*

### Significant Interpretations, Alternative Test Methods, New Technologies

None

### Inspection/Tests Required

	Yes, NA, See Report ... / Approval ... / Annex ...	Test location	Dates	Engineer
Markings:	Yes	Vega Auto Accessories Pvt. Ltd. Testing Laboratory - Belgaum	10 July 2025 to 11 July 2025	Swapnil S Mandekar/ Ravi Reddy
General Specifications:	Yes			
Impact Absorption:	Yes			
Projection and Surface Friction:	Yes			
Rigidity:	Yes			
Retention System (Dynamic):	Yes			
Retention (Detaching):	Yes			
Micro-slip of the Chin Strap:	Yes			
Resistance to Abrasion of the Chin Strap:	Yes			
Retention Systems Relying on Quick Release Mechanism:	Yes			
Tests for Oblique impact and measurement of rotational acceleration:	Yes			





**Component Specification Tested**

Style of Helmet:	Protective helmet with lower face "P" type
<u>Size</u>	
Shell Size:	Single Shell
Consumer Size:	XL (61 cm), L (59-60 cm), M (57-58 cm), S (55-56 cm), XS (53-54 cm)
Weight:	1550 ± 50 (each size)
<u>Materials</u>	
Shell:	ABS
Padding:	Polyester cloth backed with polyurethane foam/ synthetic leather or pure leather
Liner:	Expanded polystyrene
Chin Strap:	Polyester (21 mm)
<u>Retention System</u>	
Type:	Chin Strap (Double D Ring & Quick Release Mechanism)
Buckle:	Yes, Refer Annex 5A & 5B in information document
Strap Retainer:	Yes Double D Ring: Refer Annex 5A & Quick Release Mechanism: Annex 5B
Anchorage:	By Rivets Ø4.0 mm X 10 mm, 2 Nos. (Refer Annex-4)
Ventilation System:	NA
Type of Shell Edging:	EPDM Rubber & PVC (Poly Vinyl Chloride)
Accessories:	No any specific accessories.
Reflecting Band:	NA
Conspicuity marking:	NA
Additional Features:	NA

**Manufacturer's Documentation**

Manufacturer's documentation is complete and reflects the agreed specification for the ~~vehicle / engine~~ / component tested and covers all variants and versions agreed in the worst case rationale. Yes

Information document uploaded to the job folder or work order documents and identified by the job number or work order number.. Yes

**Facility and Equipment Checks**

Facility Appraisal reference number and date: Ad-hoc appraisal has been verified before test and ISO 17025 accredited lab

Calibration certificates are traceable to national or international standards of measurement, and stored in job folder or work order documents: Yes

Calibration checked and valid, recorded in the below table:

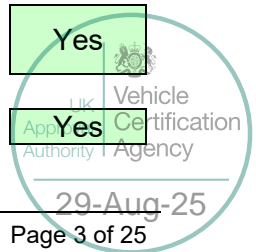



## Equipment

Description	Make	Model	Serial number	Calibration due date*
Impact Test Set-up	DTS	6DX-A,500 g, 8 Kdeg/sec (2000 hz)	6DXA0016	20/08/2025
Ultraviolet-Radiation Conditioning Chamber	Yudian	--	VA/UV/12 (B)	25/06/2026
Ultraviolet-Radiation Conditioning Chamber timers	Delta	--	VA/UV/12 (C, E, F)	02/06/2026
Ultraviolet-Radiation Conditioning Chamber timers	Delta	--	VA/UV/12 (D)	02/05/2026
Temp indicator/controller with sensor (low temp. conditioning)	Subzero	--	VA/TC/03	25/06/2026
Temp indicator/controller with sensor (Heat conditioning)	Thermotech	--	VA/OV/05(A)	25/06/2026
Temperature controller with sensor	Vigital	--	VA/HC/04 (A)	25/06/2026
Humidity controller	Vigital	--	VA/HC/04 (B)	02/06/2026
Rigidity Testing Machine (Uniaxial testing machine)	GSP	--	VA/RT/13	03/06/2026
Degree protector for detaching test	Kristeel	--	VA/AP/06	08/01/2026
Head Forms (535 mm)	GTM	--	VA/MFH/28	02/03/2026
Head Forms (575 mm)	GTM	--	VA/MFH/29	02/03/2026
Head Forms (605 mm)	GTM	--	VA/MFH/30	02/03/2026
Tensile testing machine	GSP	--	VA/TTM/01	03/06/2026
Scale for Tensile Machine for chin strap	Omega	--	VA/MS/05	24/04/2026
Digital stop watch (Dynamic test of retention system)	Racer	--	VA/SW/01	08/01/2026
Measuring scale (Dynamic test of retention system)	Omega	--	VA/MS/011	08/01/2026
Dead weight (Dynamic test of retention system)	Vega	Vega	VA/DW/11	08/01/2026
Peripheral vision test/helmet marking (angle gauge)	AD engineering	--	VA/AG/01	04/08/2025



Weighing balance machine	Seico	--	VA/WB/01	08/01/2026
Micro slip & Resistance to abrasion pressure gauge	Spac	--	VA/PG/02	08/01/2026
Micro slip & Resistance to abrasion dead weight	Vega	Vega	VA/DW/18(A)	19/06/2026
Projection and surface friction dead weight	GSP	--	VA/DW/19	03/07/2026
Projection and surface friction load cell with indicator	GSP	--	VA/PLC/01	23/06/2026
Projection and surface friction (pressure gauge)	Spac	--	VA/PG/03	08/01/2026

\*Specify calibrated date + (interval) or calibration due date.

### Equipment Remarks

Nil

Note: VCA apply measurement uncertainty to calibrated items and require pass results including equipment uncertainty.

### Software used in Testing

Description	Make	Version	Validation method
Impact Absorption	AD engg (DLSR)	IS: 7790DEAEIIFA Version: 3.4.5	Testing
--	--	--	--
--	--	--	--



<b>Inspection/Test Requirements</b>	<b>Complies Yes / NA</b>
-------------------------------------	------------------------------

**Markings**

4.1.1.	On the helmet, it bears the applicant's trade name or mark, and an indication of the size and, if appropriate, an indication of the unsuitability of the lower face cover to offer any protection against impacts to the chin.	Yes
4.3.	Marking is not placed within the main visibility area.	Yes
4.4.	Marking is indelible, clearly legible and in a readily accessible place.	Yes
8.2	Raw data of test paragraph 7.13. stored by the technical service and available to the approval authority. (for the purpose of improvement of the Regulation at a later stage.)	Yes

**General Specifications**

6.1.	Basic construction of the helmet is in the form of a hard outer shell, containing additional means of absorbing impact energy and a retention system.	Yes
6.2.	Protective helmet may be fitted with ear flaps and a neck curtain. It may also have a detachable peak, a visor, additional sun shield, electronic equipment or accessories and a lower face cover. If fitted with a non-protective lower face cover, the outer surface of the cover is marked 'Does not protect chin from impacts' and/or with the symbol shown in Figure 1 below, indicating the unsuitability of the lower face cover to offer any protection against impacts to the chin.	Yes (Protective helmet with lower face & with outer visor,)



Note: this symbol or indication must be visible and extend over at least 2 cm<sup>2</sup>

6.3.	No component or device is fitted to or incorporated in the protective helmet, unless it is designed in such a way that it will not cause injury and that, when it is fitted to or incorporated in the protective helmet, the helmet still complies with the requirements of this regulation.	Yes
	Accessories are fitted in accordance with the helmet manufacturer's instructions and, if it is the case, also in accordance with the accessory manufacturer's instructions.	Yes

UK Vehicle  
Approval Certification  
Authority Agency

29-Aug-25



	<p>Only approved helmets and approved accessories according to this Regulation can guarantee the performance of the combination of them.</p>	
6.3.1.1	<p>Helmets may be prepared for fitting universal accessories:</p> <p>Helmet has markings on the exterior of the helmet shell or any visible component as a reference for the installation of the universal accessories main external components.</p> <p>Area where the universal accessories are fitted is at least 30 mm of distance from any point of any impact affected area to the lower edge of the helmet shell (the lower rubber rim is considered to be helmet shell for this purpose).</p>	NA (Without accessories)
6.3.1.2	<p>Installation of exterior accessories is done in such a way that no part of a universal accessory, whose maximum main unit(s) dimensions are as defined in Annex 20, are located in an impact affected area.</p> <p>Helmet designed to be fitted with universal accessory has either appropriate space for attaching the device or clamp fixation system as foreseen in Annex 20. A space or clamp fixation has been provided on both sides of the helmet for each declared position symmetrically located with respect to the longitudinal vertical plane.</p> <p>At least one position for accessories fixation has been declared.</p>	NA (Without accessories)
6.3.1.3	<p>If the helmet fulfils the requirements of 6.3.1.1. and 6.3.1.2. it has been marked as ready for Universal Accessories "UA".</p> <p>Helmets marked as "UA" have also fulfilled the additional requirements and tests prescribed by this Regulation.</p>	NA (Without accessories)
6.3.1.4	<p>If the helmet is prepared for speakers, the helmet has a dedicated space of at least 41 mm diameter and a depth of at least 8 mm. Optionally, the helmet may be prepared for bigger speakers and, in this case, the related diameter shall be increased to at least 46 mm diameter.</p> <p>Helmet has been prepared to accommodate the wires for the speakers, if there is no special arrangement for the wires, the above-mentioned diameters have been increased by 2 mm.</p> <p>Helmet has been tested to assess that the appropriate speaker simulators, as defined in Annex 20, have no adverse effect and that in any case the helmet still complies with all the requirements as set forth in Chapter 7.3.</p> <p>In this case, the helmet shall be marked as "S" or "S45" depending on the assessment done.</p>	NA (Without accessories)





6.3.1.5	<p>For helmets designed for fitting speakers, minimum distance between the speakers allows a headform of the appropriate size to pass through them. This requirement has to be met for a speaker of 12mm thickness and the maximum declared diameter.</p>	NA (Without accessories)
6.3.1.6	<p>If the helmet is prepared to fit microphone and the helmet is of type P or P/J, the helmet has been tested to assess that the microphone simulator defined in Annex 20, located in a specific location foreseen on the helmet for the microphone or, if there is not such a specific location perfectly marked, the worst case position at the discretion of the Technical Service, has no adverse effect and that in any case the protective helmet still complies with all the requirements as set forth in Chapter 7.3.</p> <p>In this case, the helmet is marked as "M". Any helmet ready for universal accessories of type J or NP shall be marked as "M".</p>	NA (Without accessories)
6.3.1.7	<p>If the helmet has the accessory space or clamping fixation in the front-side position, the helmet is marked as "F".</p>	NA
6.3.1.8	<p>If the helmet has the accessory space or clamping fixation in the side position, the helmet is marked as "L".</p>	NA
6.3.1.9	<p>If the helmet is prepared to fit a rear mounted accessory, the helmet is marked as "R".</p>	NA
6.3.1.10	<p>If the helmet has different declared positions to fit accessories, they are positioned in such a way that universal accessories can be fitted in all declared positions at the same time.</p>	NA
6.3.1.11	<p>When all the accessory positions declared by the helmet manufacturer are in use, the accessories do not prevent the use of any helmet mechanism.</p>	NA
6.3.2.1	<p>Helmets that can be placed on the market with specific accessories, or for which specific accessories will exist, have been tested to assess that the supplementary equipment has no adverse effect and that in any case the protective helmet and/or visor still complies with all the requirements as set forth in Chapter 7. The evaluation has been done with and without the accessory and their support.</p>	NA (Without accessories)
6.3.2.2	<p>Helmets declared as ready to fit specific accessories and has been evaluated as per the previous paragraph, are marked as "SA".</p>	NA (Without accessories)



6.4.1. Shell covers all areas above plane AA' and extends downwards at least as far as the lines 'CDEF' on both sides of the headform. Yes

Note: See Annex 4, Figure 1A.

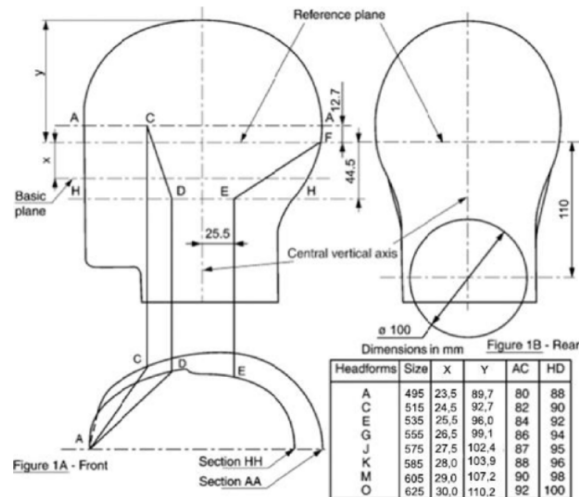

6.4.2. At the rear, the rigid parts and, in particular, the shell, are not within a cylinder, defined as follows: Yes

- Diameter: 100 mm;
- Axis situated at the intersection of the medium plane of symmetry of the headform and of a plane parallel to and 110 mm below the reference plane.

Note: See Annex 4, Figure 1B.

6.4.3. Protective padding covers all the areas defined in paragraph 6.4.1, with account being taken of the requirements of paragraph 6.5. Yes

6.5. Helmet does not dangerously affect the wearer's ability to hear. Yes

6.5. Temperature in the space between the head and the shell does not rise inordinately. Yes  
(Vents provided)

Note: To prevent this, ventilation holes may be provided in the shell.

6.5. Where means for attaching a visor are not provided, the profile at the front edge does not prevent the wearing of goggles. Yes

6.6. All projections from, or irregularities in the outer surface of the shell greater than 2 mm, are tested for shear assessment according to paragraphs 7.4.1 or 7.4.2. The outer surface of the helmet is tested for friction assessment, according to paragraphs 7.4.1 or 7.4.2. This applies in particular to a movable lower face cover in all positions intended by the manufacturer. Yes

6.7. All external projections are radiused and any external projections other than press-fasteners are smooth and adequately faired. Yes  
(no any sharp edges)

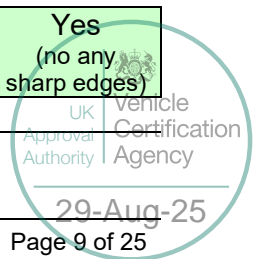



6.7.1.	All external projections not more than 2 mm above the outer surface of the shell (e.g. rivet heads) have a radius of a minimum of 1 mm.		Yes
6.7.2.	All external projections more than 2 mm above the outer surface of the shell have a radius of a minimum of 2 mm. <i>Note: Latter specific requirements do not apply if a projection satisfies the requirements in paragraphs 7.4.1 or 7.4.2 below.</i>		Yes
6.8.	There are no inward-facing sharp edges on the inside of the helmet; rigid, projecting internal parts are covered with padding so that any stresses transmitted to the head are not highly concentrated.		Yes
6.9.	Various components of the protective helmet are so assembled that they are not liable to become easily detached as a result of an impact.		Yes
6.9	In the case of visor and movable or detachable lower face cover, only when in not protective position, the detachment is acceptable provided that it is complete and not to cause possible injuries to the user		NA
6.10.	Retention systems are protected from abrasion.		Yes
6.11.	Helmet is held in place on the wearer's head by means of a retention system, which is secured under the lower jaw. All parts of the retention system are permanently attached to the system or to the helmet.		Yes
6.11.1.	If the retention system includes a chin-strap, the strap is not less than 20 mm wide under a load of 150 N ± 5 N, applied under the condition prescribed in paragraph 7.6.2:	21 mm	Yes
6.11.2.	Chin strap does not include a chin cup.		NA
6.11.3.	Chin straps are fitted with a device to adjust and maintain tension in the strap.		Yes
6.11.4.	Chin strap fastening and tensioning devices are positioned on the straps so that: - There are no rigid parts extending more than 130 mm vertically below the headform reference plane, with the helmet mounted on the appropriate sized headform* - The whole of the device is between the bony projections of the underside of the lower jaw* <i>*Strikethrough, as appropriate.</i>		Yes
6.11.5.	If the retention system includes either a double-D ring or sliding bar fastening device ("roller buckle"), then means are provided to prevent the retention system being completely undone and also to retain the free end of the strap when the retention system is		Yes (Double D ring)

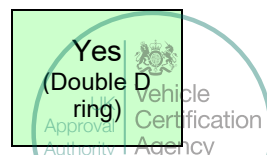



	adjusted. (If the retaining system can be opened completely, it must be possible only with voluntary action. To prevent any possible misuse, the helmet must be provided with detailed instructions on the use of the buckle if required.)	
6.11.6.	Sliding bar and double-D ring fastening devices are fitted with a pulling flap to be used for releasing the retention system. Its colour is red and its minimum dimensions are 10 x 20 mm.	Yes
6.11.7.	If a retention system includes a quick-release mechanism, then the method of release of this mechanism is self-evident. Any levers, tabs, buttons or other components that need to be operated to release the mechanism are coloured red; those parts of the rest of the system that are visible when closed are not similarly coloured, and the mode of operation is permanently indicated.	Yes
6.11.8.	Retention system remains closed when the tests described in paragraphs 7.3, 7.6 and 7.7 are carried out.	Yes
6.11.9.	Buckle of the retention system is designed so as to preclude any possibility of incorrect manipulation. This means inter alia (among other things) that it is not possible for the buckle to be left in a partially closed position.	Yes
6.12.	If the lower face cover is detachable or movable, the lower face cover is fitted with a device that maintains the intended position even during the complete series of impacts and retention (detaching) test. The device is such that incorrect handling is impossible. The control/actuating device must be of red colour. The helmet must comply with the requirements for helmet categories "J", "P" or both.	NA
6.13.	Characteristics of the materials used in the manufacture of helmets are known not to undergo appreciable alteration under the influence of ageing or of the circumstances of use to which the helmet is normally subjected, such as exposure to sun, extremes of temperature and rain. For those parts of the helmet coming into contact with the skin, the materials used are known not to undergo appreciable alteration through the effect of perspiration or of toilet preparations. The manufacturer does not use materials known to cause skin troubles. The suitability of a proposed new material is established by the manufacturer.	Yes
6.14.	After the performance of one of the prescribed tests, the protective helmet does not exhibit any breakage or deformation dangerous to the wearer. Note: As example visor sunshield and shell significant cracks or any part partially detached (spoiler, lower face cover, accessories) that can hurt the user while he's rolling on the road.	Yes





**Peripheral Vision**

6.15.1 6.15.2	The technical service has selected from among the existing sizes of a helmet type the size it considers likely to yield the least favourable result and helmet placed on the headform corresponding to its size by the procedure set out in Annex 5 to this Regulation;	<div style="border: 1px solid black; background-color: #d4f1d4; padding: 10px; width: 100px; margin: 0 auto;">Yes</div>
6.15.3.	There is no occultation in the field of vision bounded by:	<div style="border: 1px solid black; background-color: #d4f1d4; padding: 10px; width: 100px; margin: 0 auto;">Yes</div>
6.15.3.1.	- Horizontally: Two segments of dihedral angles symmetrical in relation to the median longitudinal vertical plane of the headform and situated between the reference and the basic planes. Each of these dihedral angles is defined by the median longitudinal vertical plane of the headform and the vertical plane forming an angle of not less than 105° with the median longitudinal vertical plane and whose edge is the straight line LK;	
6.15.3.2.	- Upwards: Dihedral angle defined by the reference plane of the headform and a plane forming an angle of not less than 7° with the reference plane and whose edge is the straight line L <sub>1</sub> L <sub>2</sub> , the points L <sub>1</sub> and L <sub>2</sub> representing the eyes;	
6.15.3.3.	- Downwards: Dihedral angle defined by the basic plane of the headform and a plane forming an angle of not less than 45° with the basic plane, and whose edge is the straight line K <sub>1</sub> K <sub>2</sub> .	

**Visors**

6.16.1.	Systems of attachment of a visor to a helmet is such that the visor is removable. It is possible to manoeuvre the visor out of the field of vision with a simple movement of one hand. (However, the latter prescription may not be required for helmets which do not provide chin protection provided that a label is attached to the helmet to the effect of warning the purchaser that the visor cannot be manoeuvred.)	<div style="border: 1px solid black; background-color: #d4f1d4; padding: 10px; width: 100px; margin: 0 auto;">Yes</div>
6.16.2.	Angle opening (see annex 9) ≥ 5°:	<div style="border: 1px solid black; background-color: #d4f1d4; padding: 10px; width: 100px; margin: 0 auto;">Yes</div>

**Sun Shield**

6.17.1	Sun shield does not restrain or prevent the movement of the visor. On opening the visor, the sun shield can pivot in the working position. By means of a simple movement the sun shield is able to be moved separately from the visor out of the visual field.	<div style="border: 1px solid black; background-color: #d4f1d4; padding: 10px; width: 100px; margin: 0 auto;">NA</div>
6.17.2.1	Sun shield does not restrict the field of vision given in paragraph 6.15. in the working or parking position. If the sun shield is fixed outside of the visor, the surface may include fixings or devices to make movement possible. The total surface of the fixings or devices does not exceed 2cm <sup>2</sup> ; they can be distributed on both sides of the field of vision.	<div style="border: 1px solid black; background-color: #d4f1d4; padding: 10px; width: 100px; margin: 0 auto;">NA</div>





### Conspicuity Marking

6.18.1. In order to comply with national requirements for use, the helmet may be required by individual Contracting Parties to contribute to the conspicuity of the user both during the daytime and at night from the front, rear, right and left, by means of parts made of reflective materials that conform to the specifications laid down in paragraphs 6.16.2 to 6.16.6 of this regulation. NA

6.18.1. It is allowed that the helmet is equipped with reflective materials in the box, with proper indications to the user on where and how to apply them on the helmet.  
*Note: Mandating of conspicuity marks is left to the discretion of individual Contracting Parties. Article 3 of the Agreement to which this regulation is annexed does not prevent the Contracting Parties from prohibiting the use of helmets not meeting the conspicuity requirements.* NA

### 6.18.2 Reflective Parts

6.18.2.1. Total surface area and shape of the reflective part used is such that in each direction, corresponding to one of the areas defined in the figure below, visibility is ensured by a surface area of at least 18 cm<sup>2</sup> of simple shape and measured by application on a plane. NA

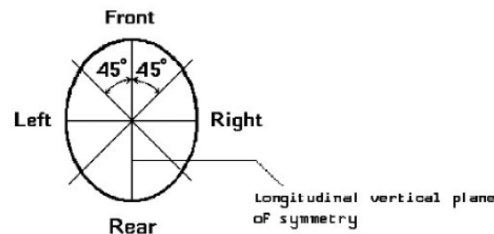

6.18.2.1. In each surface area of minimum 18 cm<sup>2</sup>, it is possible to mark either a:  
- Circle of 40 mm diameter\*  
- Rectangle of at least 12.5 cm<sup>2</sup> in surface area and at least 20 mm in width\* NA

6.18.2.1. Each of these surfaces are situated as near as possible to the point of contact with the shell of a vertical plane parallel to the longitudinal vertical plane of symmetry, to the right and to the left, and as near as possible to the point of contact with the shell of a vertical plane perpendicular to the longitudinal plane of symmetry, to the front and to the rear. NA

6.18.3. Each of the retro-reflective areas emit white light when it is illuminated with standard illuminant A, with an observation angle of 1/3° and an illumination angle  $\beta_1 = \beta_2 = 0^\circ$  (or  $\beta_1 = \pm 5^\circ, \beta_2 = 0^\circ$ ). NA





6.18.4. Minimum value of the luminous intensity coefficient of a surface area of 18 cm<sup>2</sup> of material, when revolved, is not less than the values specified in the table below, expressed in millicandelas per lux. NA

Angle of Divergence (°)	Angle of Illumination (°)		
	0	20	40
20	100	60	25

6.18.5. After each conditioning as described in paragraph 7.2, the helmet is visually inspected. There are no signs of cracking or appreciable distortion of the retro-reflective material. NA

6.18.6. Neither the adhesive nor the retro-reflective material affects the mechanical performance of the helmet according to the related tests in this regulation. NA

**Tests**

Each helmet type, fitted with its visor if placed on the market with a visor, conditioned as shown below.

Test	Number of helmets to be conditioned				Total
	ambient-temperature and hygrometry conditioning	Heat conditioning	low-temperature conditioning	ultra- violet radiation conditioning and moisture conditioning	
Impact absorption	2	1	1	1	5
Imp. Abs. extra point	2				2
Hi/Low energy impact	2				2
Rotational	2				2
Projection and surface friction	1				1
Rigidity	2				2
Retention system	1				1
					15

Yes  
(with outer visor)

**Testing Notes:**

The largest size of each combination shell size and protective padding of each helmet type shall be tested for impact absorption, rotational and rigidity. For impact absorption on extra point, Hi and Low energy impacts and tests of the retention system, helmet sizes shall be chosen such that the helmet to be tested shall be that offering the likely least favorable conditions (such as thickest padding, etc).

7.1 All the types of retention systems available for the helmet must be tested. Supplementary samples could be necessary. Additionally, for each smaller headform size within the size range of the helmet type two helmets shall undergo the impact absorption test. One helmet shall be heat conditioned, and the other low temperature conditioned. The conditioned helmets shall be impacted against either anvil, in equal numbers if possible, at the choice of the laboratory. Yes

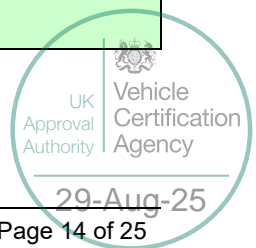



### Types of Conditioning

7.2	Prior to any type of further conditioning for mechanical tests, as specified in paragraph 7.1., each helmet shall be subject:	Yes
7.2.1.	Ambient-temperature and hygrometry conditioning: The helmet shall be exposed to a temperature of $25\text{ }^{\circ}\text{C} \pm 5\text{ }^{\circ}\text{C}$ and a relative humidity of 50 per cent $\pm 10$ per cent for at least 4 hours.	Yes
7.2.2.	Heat conditioning: The helmet shall be exposed to a temperature of $50\text{ }^{\circ}\text{C} \pm 2\text{ }^{\circ}\text{C}$ for not less than 4 hours and not more than 8 hours.	Yes
7.2.3.	Low-temperature conditioning: The helmet shall be exposed to a temperature of $-10\text{ }^{\circ}\text{C} \pm 2\text{ }^{\circ}\text{C}$ for not less than 4 hours.	Yes
7.2.4.	Ultraviolet-radiation conditioning and moisture conditioning. The outer surface of the protective helmet shall be exposed successively to: ultraviolet irradiation by a 150-watt xenon-filled quartz lamp for 48 hours at a range of 25 cm; spraying for 4 to 8 hours with water at ambient temperature at the rate of 1 litre per minute.	Yes



## Test Results

### Impact Absorption Tests

7.3.1.4.

The tests completed not more than five minutes after the helmet is taken from the conditioning chamber.

Yes

7.3.

Helmet size:

XL (61 cm)

Helmet ID Number	H.F. Size Number	Impact Point	Anvil*	Cond. (°C)	Speed (m/s)	HIC ( $\leq 2,400$ )	Deceleration ( $\leq 275 g$ )
XL - 01	M (605 mm)	B	K	AMB	7.53	1305.1	188
		X	K		7.62	1432.4	230
		P	K		7.52	1398.8	167
		R	K		7.6	1450.3	201
XL - 02	M (605 mm)	B	F	AMB	7.6	1763.8	211
		X	F		7.62	1925.7	236
		P	F		7.64	1828.8	269
		R	F		7.6	1985.9	231
XL - 03	M (605 mm)	B	K	+50	7.59	1401.2	209
		X	K		7.6	1516.2	229
		P	K		7.54	1409.6	158
		R	K		7.57	1342.3	180
XL - 04	M (605 mm)	B	F	-10	7.55	1257.6	174
		X	F		7.52	1128.2	164
		P	F		7.59	1816.9	193
		R	F		7.62	2225.6	252
		S	F		6.11	646.5	163
XL - 05	M (605 mm)	B	K	UV + H2O	7.52	1313.9	176
		X	K		7.5	1278.3	173
		P	K		7.54	1646.6	186
		R	K		7.6	1523.5	219

\*F = Flat; K = Kerbstone



7.3.

Helmet size:

**XL (61 cm)**

Extra Impact points (Worst Case Size Selected):

Helmet ID Number	H.F. Size Number	Impact Point	Anvil <sup>1</sup>	Cond. (°C)	Required Speed (m/s)	Measured Speed (m/s)	HIC requirement	Measured HIC	Decel requirement	Measured Decel	
XL-06	M (605 mm)	BXL	F	AMB	7.5	7.6	≤ 2,400	1494.8	≤ 275 g	231	
		XPR	F		7.5	7.59	≤ 2,400	1635.6	≤ 275 g	218	
		XRL	F		7.5	7.58	≤ 2,400	1676.5	≤ 275 g	197	
XL-07	M (605 mm)	BXL	K		7.5	7.53	≤ 2,400	1348.4	≤ 275 g	179	
		XPR	K		7.5	7.63	≤ 2,400	1972.2	≤ 275 g	271	
		XRL	K		7.5	7.54	≤ 2,400	1345.5	≤ 275 g	179	
XL-08 (high energy)	M (605 mm)	B	F		AMB	8.2	8.25	≤ 2,880	2214.3	≤ 275 g	239
		X	F			8.2	8.28	≤ 2,880	2332.9	≤ 275 g	266
		P	F			8.2	8.3	≤ 2,880	2780.3	≤ 275 g	273
		R	F	8.2		8.28	≤ 2,880	2676.2	≤ 275 g	260	
XL-09 (low energy)	M (605 mm)	B	F	6.0		6.03	≤ 1,300	697.9	≤ 180 g	140	
		X	F	6.0		6.01	≤ 1,300	654.2	≤ 180 g	131	
		P	F	6.0		6.08	≤ 1,300	994.5	≤ 180 g	167	
		R	F	6.0		6.02	≤ 1,300	713.3	≤ 180 g	139	

<sup>1</sup>: F = Flat; K = Kerbstone

<sup>2</sup>: Extra test locations to be selected from the 12 listed in section 7.3.4.2.1

Helmet size:

**L (59-60 cm)**

(Tested on largest size)

Helmet ID Number	H.F. Size Number	Impact Point	Anvil*	Cond. (°C)	Speed (m/s)	HIC (≤ 2,400)	Deceleration (≤ 275 g)
L-10	M (605 mm)	B	K	+50	7.53	1198.9	164
		X	K		7.56	1318.8	178
		P	K		7.58	1715.2	185
		R	K		7.62	1677.2	222
L-11	M (605 mm)	B	F	-10	7.53	1341.5	174
		X	F		7.6	1595.9	219
		P	F		7.61	2158.2	224
		R	F		7.6	1323.8	203

\*F = Flat; K = Kerbstone

Helmet size:

**M (57-58 cm)**

(Tested on largest size)

Helmet ID Number	H.F. Size Number	Impact Point	Anvil*	Cond. (°C)	Speed (m/s)	HIC (≤ 2,400)	Deceleration (≤ 275 g)
M-10	J (575 mm)	B	K	+50	7.52	1197.5	158
		X	K		7.56	1392	181
		P	K		7.57	1637.6	190
		R	K		7.6	1689.8	240
M-11	J (575 mm)	B	F	-10	7.56	1350.4	184
		X	F		7.56	1336.7	188
		P	F		7.61	1919.6	223
		R	F		7.62	1599.6	231

\*F = Flat; K = Kerbstone

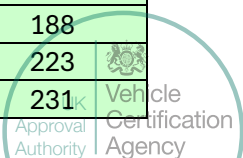

29-Aug-25



Helmet size:

S (55-56 cm)

(Tested on largest size) (worst case done)

Helmet ID Number	H.F. Size Number	Impact Point	Anvil*	Cond. (°C)	Speed (m/s)	HIC (≤ 2,400)	Deceleration (≤ 275 g)
S-12	E (535 mm)	B	F	AMB	7.52	1191.8	155
		X	F		7.6	1530.1	202
		P	F		7.62	1836.1	211
		R	F		7.63	1537.5	230
S-13	E (535 mm)	B	K	AMB	7.52	1311.6	169
		X	K		7.56	1558.9	191
		P	K		7.58	1762	194
		R	K		7.62	1619.1	256
S-14	E (535 mm)	B	K	+50	7.54	1226.1	163
		X	K		7.57	1426.7	203
		P	K		7.55	1523	167
		R	K		7.58	1442.1	201
S-15	E (535 mm)	B	F	-10	7.6	1894.9	227
		X	F		7.62	2212.9	262
		P	F		7.61	2066.5	236
		R	F		7.63	2311.5	272
S-16	E (535 mm)	B	F	UV + H2O	7.54	1305.6	183
		X	F		7.51	1146	165
		P	F		7.57	1647.8	194
		R	F		7.6	1731.3	230

\*F = Flat; K = Kerbstone

Helmet size:

XS (53-54 cm)

(Tested on largest size)

Helmet ID Number	H.F. Size Number	Impact Point	Anvil*	Cond. (°C)	Speed (m/s)	HIC (≤ 2,400)	Deceleration (≤ 275 g)
XS-17	E (535 mm)	B	K	+50	7.58	1323.7	168
		X	K		7.62	1524.8	216
		P	K		7.57	1551.9	164
		R	K		7.6	1333.6	198
XS-18	E (535 mm)	B	F	-10	7.58	1265.3	181
		X	F		7.58	1340.1	179
		P	F		7.59	1618.5	195
		R	F		7.62	1538.3	219

\*F = Flat; K = Kerbstone



### Test for Projection and Surface Friction (Method B)

	Helmet ID Number	Test	Tested Point	Results
7.4.2.1.3.1.	XL-21	Projection	Side	Pass
7.4.2.1.3.2.	XL-22	Surface	Top	Pass

### Test for projections of the category P/J with movable lower face cover

7.4.3.1	Strength assessment of the movable face cover in the position "J", the helmet placed on the appropriate test head form selected from Annex 4 in compliance with paragraph 7.3.1.3.1.	NA
7.4.3.2	Falling mass of 4 kg ± 0.01 kg released in guided free fall from a height of 600 ± 5 mm hooked on to the front part of the chin section in the position "J" in the median vertical plane of the helmet.	NA
7.4.3.3	Test apparatus used to apply a shock load to a helmet secured to the headform by its own retention system. Headform secured in a test fixture with its vertical axis pointing upward at 45° to the direction of gravity. Equipment allows drop weight to slide in a guided free fall to impact a rigid stop anvil. Mass of the guide is 1.0 -0.0 +0.2 kg. Impact speed not less than 95 per cent of the theoretical speed.	NA
7.4.3.4	Movement such to avoid any possible interference of the chin guard with 100 mm cylinder as defined in paragraph 6.4.2. (Partial detachment is not acceptable.)	NA

### Rigidity Tests

7.5.1.	The test helmets have undergone ambient-temperature and hygrometry conditioning.	Yes
--------	--	-----

Helmet ID Number	Helmet Size	Load Direction	Deformation (mm)		
			Initial (load 30 N)	Max (load 630 N) (≤ 40 mm)	Final (load 30 N) (≤ 15 mm)
XL-23	XL (61 cm)	Longitudinal	1.2	17.2	8.1
XL-24	XL (61 cm)	Transversal	1.5	10.1	5.9
XS-25	XS (53-54 cm)	Longitudinal	1.3	16.8	7.5
XS-26	XS (53-54 cm)	Transversal	1.1	9.8	5.1



### Dynamic Test of the Retention System

7.6.1	Helmet is positioned as prescribed in paragraph 7.3.1.3.1.	Yes
7.6.2	Set up is as per 7.6.2 and Annex 8, Figure 2	Yes
7.6.3	Falling mass of 10 kg ± 0.1 kg released drops in guided free fall from a height of 750 ± 5 mm.	Yes
7.6.4	During the test, the dynamic displacement of the point of application of the force shall not exceed 35 mm	Yes
7.6.5	After two minutes, the residual displacement of the point of application of the force, as measured under a mass of 15 kg ± 0.5 kg, does not exceed 25 mm.	Yes

Helmet ID Number	Helmet Size	Chin Strap	Extension Dynamic (≤ 35 mm)	Extension Residual (≤ 25 mm)
XL-27	XL (61 cm)	D-ring	17.1	0.2
XS-28	XS (53-54 cm)	D-ring	16.5	1.6
XL-27	XL (61 cm)	Quick release Mechanism	16.1	0.2
XS-28	XS (53-54 cm)	Quick release Mechanism	18.2	1.3

### Retention (Detaching) Test

7.7.1.	The test helmets have undergone ambient-temperature and hygrometry conditioning.	Yes
7.7.6.	Modular helmets tested in J and P configuration.	NA

Helmet ID Number	Helmet Size	Chin Strap	After the Test (Angle ≤ 30°)
XL-29	XL (61 cm)	D-ring	22.5°
XS-30	XS (53-54 cm)	D-ring	24°
XL-29	XL (61 cm)	Quick release Mechanism	23.9°
XS-30	XS (53-54 cm)	Quick release Mechanism	25°

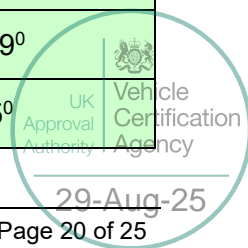



### Micro-slip Test of the Chin Strap

Note: See Annex 8, Figure 4)

Chin strap	Total Slip ( $\leq 10$ mm)
XL-CS-01	1.5
XS-CS-02	1.1

### Test for Resistance to Abrasion of the Chin Strap

Note: See Annex 8, Figure 5.

7.11.5 Strap tested to a tension of 3 kN without breaking. Yes

Chin Strap	Tension of 3 kN
XL-CS-03	3.09 kN
XS-CS-04	3.05 kN

### Tests for Retention Systems Relying on Quick Release Mechanism

7.12.2 Tests carried out as per the procedures of 7.12.2 in the order given. Yes

	Helmet ID Number	Test	Results
7.12.1.	--	Inadvertent release by pressure	--
7.12.2.	QRM-01	Ease of release (Max. load $\leq 30$ N or $\leq 60$ N)	34.9 N
7.12.3.2.	QRM-01	Durability of quick release mechanisms (Release after 5,000 cycles)	Yes
7.12.3.3.	QRM-01	Durability of quick release mechanisms (Saline spray)	Yes
7.12.3.4.	QRM-01	Durability of quick release mechanisms (Traction 2 kN $\pm$ 50 N)	2.05 kN



**Tests for Oblique impact and measurement of rotational acceleration**

7.13	The test helmets have undergone ambient-temperature and hygrometry conditioning.	Yes
Annex 7, 2.4.	Coefficient of friction (m) $0.3 \pm 0.05$ between the outer surface of the head form and the common fabric used in the comfort padding of the helmet.	Yes
Annex 7, 2.5.	Chin strap force controller "Tightened as for normal use".  (This means that the helmet must be tightened before each test after having applied below the chin a rigid cylinder 10 mm diameter at least 30 mm long that will be removed before the test. According paragraph 7.3.1.3. )	Yes
Annex 7, 2.6.	Instrumentation for measuring the head kinematics during impact calibrated in line with Annex 7, 2.6.	Yes
Annex 7, 2.7.	Headform coefficient of friction calibrated in line with Annex 7, 2.7.	Yes
Annex 7, 3.1	Helmet placed on a headform of appropriate size in accordance with the requirements of Annex 5. Helmet positioned in accordance to the HPI (helmet positioning index) provided by the manufacturer.  If it is not available, the helmet shall be tipped towards the rear so that the front edge of the helmet in the median plane is displaced by 25 mm.	Yes
Annex 7, 3.2.2	Anvil (A) as per Annex 7, 3.2.2 and figure 2	Yes
Annex 7, 3.	Test method in accordance with Annex 7, 3.	Yes





Helmet ID Number	H.F. Size Number	Impact Point	Cond. (°C)	Speed (8.0m/s)	Peak Resultant Acceleration (PRA) $\leq 10,400 \text{ rad/s}^2$	Brain Injury Criterion (BrIC) $\leq 0.78$
XL-31	M (60.5 mm)	Front lateral right (45°)	AMB	8.02	8562	0.35
		Rear (180°)		8.03	8572	0.37
		Lateral left (270°)		8.03	8518	0.32
XL-32	M (60.5 mm)	Front (0°)	AMB	8.10	8785	0.48
		Rear-lateral right (135°)		8.04	8585	0.34

Helmet ID Number	H.F. Size Number	Impact Point	Cond. (°C)	Speed (8.0m/s)	Peak Resultant Acceleration (PRA) $\leq 10,400 \text{ rad/s}^2$	Brain Injury Criterion (BrIC) $\leq 0.78$
S-35	E (535 mm)	Front lateral right (45°)	AMB	8.01	8541	0.36
		Rear (180°)		8.05	8505	0.35
		Lateral left (270°)		8.05	8612	0.38
S-36	E (535 mm)	Front (0°)	AMB	8.08	8674	0.44
		Rear-lateral right (135°)		8.01	8542	0.35



### Photographs

Impact on point B

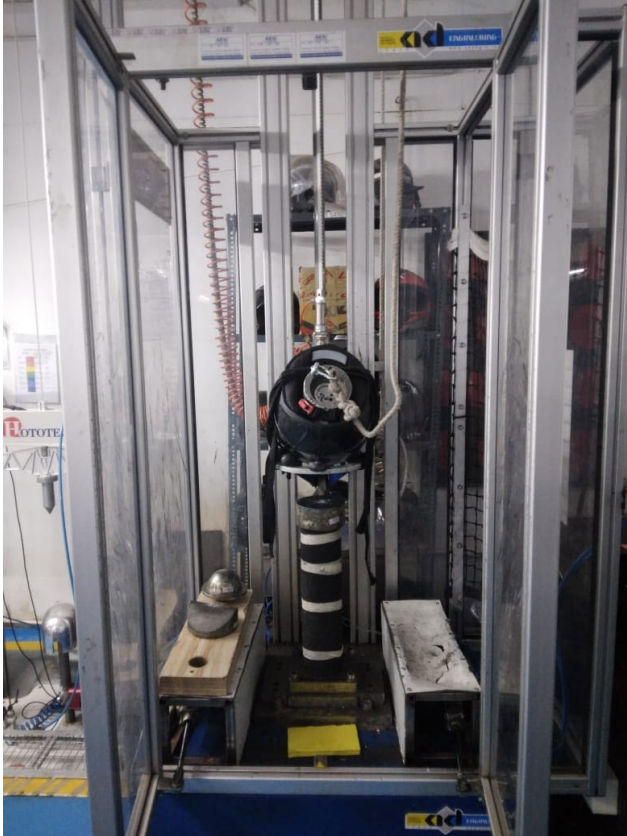

Impact on point P

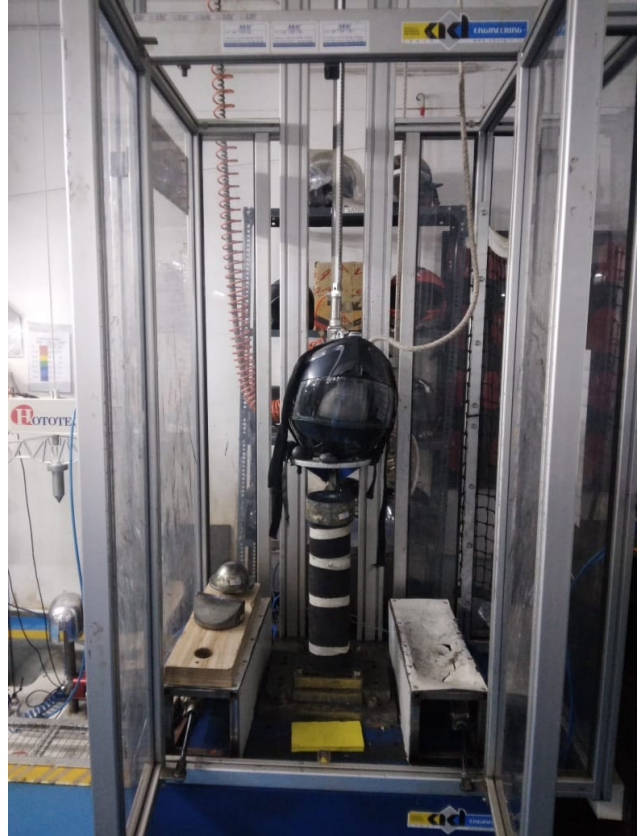

Impact on point R



Impact on point X

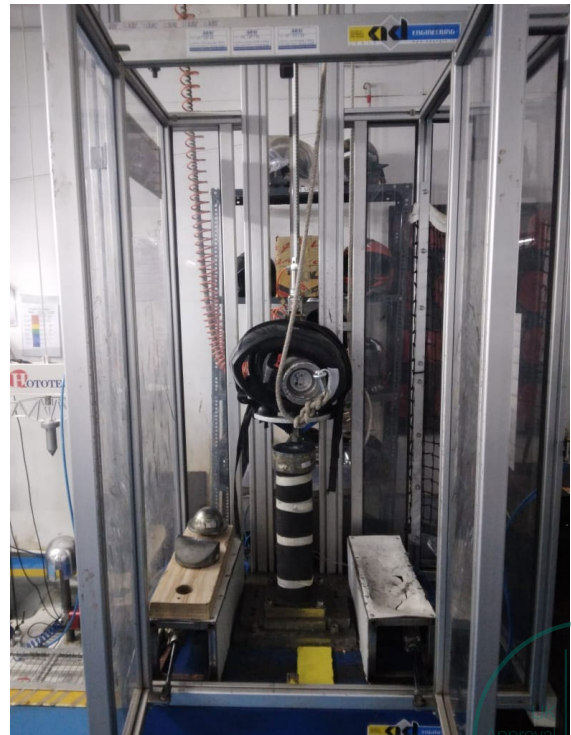



## Notes

---

*[Notes can be provided at the bottom if it is useful to provide additional information that is not covered by a compliance statement, for example glazing markings.]*

## Remarks

---

**Refer worst case rationale on page 2.**

Production qualification of helmet type STROMER "P" is determined.  
Refer PQ test report VCA027828-1A.

*Note: VCA apply measurement uncertainty to calibrated items but not test results.*